

**Proposed decision to be taken by the
Portfolio Holder for Transport and Planning
on or after 21 November 2014**

- 1) Proposed Prohibition of Driving and Revocation of One Way - Wood Street**
- 2) Proposed Waiting Restrictions – Market Hill, Park Lane, High Street, Coventry Street, Meadow Road, and Wood Street.
Proposed Disabled Parking – Market Hill**

Recommendations

That the Proposed Traffic Regulation Orders associated with the Southam Town Centre Highway Improvement Project, listed below are implemented as advertised:

- (1) Proposed Prohibition of Driving and Revocation of One Way- Wood Street
- (2) Proposed Waiting Restrictions – Market Hill, Park Lane, High Street, Coventry Street, Meadow Road, and Wood Street.

Proposed Disabled Parking – Market Hill

1.0 Introduction

- 1.1 These proposals have been advertised and are detailed in the appendix, this report considers the objections received.

2.0 Background information

- 2.1 Following the recent development of the Tesco Superstore sited on the outskirts of Southam, funding was made available to Stratford District Council through a Section 106 agreement for a Town Centre Highway Improvement Project for Southam.
- 2.2 The aim of the proposed scheme is to improve the links between local transport and the shops and businesses within the town centre area of Market Hill and High Street. The improvements will create a safer and more welcoming environment for both residents and visitors to Southam, with the intention of reviving the heritage of this historic market town.

3.0 Consultation

- 3.1 An initial formal consultation was carried out in November and December 2013 with three public exhibitions held and leaflets delivered to all businesses and residents in Southam. 82% of responses were in favour of the scheme.
- 3.2 Following comments received from shop owners in the Market Hill area, minor changes were made to the proposed layout of the parking area on Market Hill which were agreed with Stratford District Council and Southam Town Council.
- 3.3 Traffic Regulation Orders relating to the changes to on-street parking in the town centre and to the closure of a section of Wood Street were formally advertised in October 2014, in accordance with the statutory procedure. Objections have been received, and are summarised below.

4.0 Objections Received

Proposed Prohibition of Driving and Revocation of One Way – Wood Street

Objection (1) - Resident of Daventry Street

You will be removing vehicles from a street which has no residential properties (Wood Street) and increasing vehicles on Daventry Street, a predominantly residential street.

To place further traffic movements through the junction of Daventry Street and High Street and along Daventry Street without junction improvements or additional safety measures is unsafe. The majority of residential properties and shops along Daventry Street open directly onto a narrow pavement. Increasing further the traffic volumes along Daventry Street compared to the existing arrangements at the junction of Wood Street and High Street.

It is disappointing that the County Council has not published other options for Wood Street, such as narrowing the High Street carriageway, removing the right turn and increasing the width of the footway. This would not only improve the existing crossing, remove some of the perceived conflict, but also enhance the look of the town centre.

Response

It is accepted that there will be an increase in traffic movements on Daventry Street. It is also accepted that footways in Daventry Street are narrow and shops and residential properties front straight onto the footway.

However, the closure of Wood Street at High Street end will allow a continuous footway to be provided on the main shopping thoroughfare, and from the Wood Street car park onto High Street. This is considered to be a

safer environment for the majority of pedestrians accessing businesses within the town centre. Other options, such as narrowing High Street, have been considered, but do not facilitate safe pedestrian movements between Wood Street Car Park and the shopping areas along High Street and Market Hill.

Proposed Waiting Restrictions – Market Hill, Park Lane, High Street, Coventry Street, Meadow Road, and Wood Street. Proposed Disabled Parking – Market Hill

Objections (1-9) - Businesses, and (10) - Resident

Nine objections to the proposals for Market Hill have been received which follow the same format. An additional response from a resident was received which addressed the same points, as follows:

- (1) The car park is being made too small.
- (2) Concerns regarding the safety of bus users as a result of the introduction of the raised area for buses to stop in this location.
- (3) Concerned that the changes could adversely affect businesses and trade.
- (4) Funding has been made available from another major retailer. The objectors feel this is in direct competition to the local business community. They question whether it could be used elsewhere, rather than on Market Hill.

Response

- (1) The parking area is proposed to be reduced from 14 to nine spaces, with a further three spaces to be provided on High Street - a loss overall of two spaces. The current parking arrangements on Market Hill are not in accordance with current standards. This scheme aims to provide suitable, short term parking for shoppers. Long term parking is available in Wood Street Car Park, a short distance away (approx. 200 metres), from where access has been improved.
- (2) The location of the existing bus stop on Market Hill has nowhere safe for passengers to stand and wait or alight from the bus; this scheme provides a safe refuge area for bus passengers.
- (3) There is no evidence available to support or refute the concerns raised relating to the potential loss of trade due to reduced parking spaces directly outside the shops.
- (4) The funding allocated through the Section 106 agreement specified the area of the town centre where this funding must be used.

Objection (11) – Petition

A petition signed by 1029 customers of the Seastar Fish & Chip Shop has been received.

“We have a final chance to raise our objections to Southam Town Centre Council ruining the heart of Southam. By reducing the car park spaces from

14 to 9. You will have to park at Wood Street to do your banking, picking your prescription and convenience of popping in for Southam's takeaways.

Tesco paying £320,000 to modernise the town should be used wisely, not to hinder the use of town centre for Tesco's benefit."

Response

The current parking arrangements on Market Hill are not in accordance with current standards. The reduction in spaces has been necessitated by the need to improve accessibility and safety for pedestrians waiting for and alighting public transport. The reduction in number of spaces on Market Hill will be partly offset by the introduction of three additional spaces on High Street in close proximity to the Post Office, Chemist, banks and other local amenities. Pedestrian access to Wood Street Car Park will be improved by removing the conflict between pedestrians and vehicles on Wood Street by introducing a continuous footway.

5.0 Support

County Councillor John Appleton fully supports these proposals.

Stratford District Council and Southam Town Council are fully in support of these proposals.

Letters of Support Received

A resident of Long Itchington fully supports the following:

- The Closure of Wood Street
- The changes to the bus bay makings on High Street are a good idea and I support them
- The additional parking on High Street.

6.0 Financial Implications

- 6.1 All works associated with these Traffic Regulation Orders will be carried out as part of the Southam Town Centre Enhancement Scheme, which is fully funded through a Section 106 agreement, and is included in the Capital Programme 2014/15.

7.0 Background Papers

None

8.0 Supporting Papers

- 8.1 Plan of Proposed Traffic Regulation Orders
- 8.2 Scheme Proposal
- 8.3 Letters of objection, Petition, E-mails, and E-mails of support

	Name	Contact Information
Report Author	Graham Stanley	grahamstanley@warwickshire.gov.uk Tel: 01926 412076
Head of Service	Graeme Fitton	graemefitton@warwickshire.gov.uk
Strategic Director	Monica Fogarty	monicafogarty@warwickshire.gov.uk
Portfolio Holder	Cllr Peter Butlin	cllrbutlin@warwickshire.gov.uk

Southam Town Centre

Proposed Prohibition of Motor Vehicles – Wood Street, Southam

1. STATEMENT OF REASONS

Warwickshire Council are proposing to improve the links between local transport, the shops and businesses within the town centre area of Market Hill, High Street and Coventry Street, Southam. As part of these improvement works Warwickshire Council are proposing the closure of Wood Street at its junction with High Street, which will remove the current conflict between pedestrians and vehicles where both carriageway and footway are narrow. Pedestrian access from High Street will remain in place.

See Plan Ref. TR/9221-002.

2. SCHEDULE

Schedule 1 (Proposed Prohibition of Motor Vehicles)

Wood Street

That length of Wood Street from its junction with the High Street in an easterly direction for a distance of 20 metres.

Schedule 2 (Proposed Prohibition of Motor Vehicles – Except for Access)

Wood Street

That length of Wood Street from a point 20 metres east of its junction with High Street in an easterly direction for 25 metres.

3 .EXISTING ORDERS TO BE REVOKED- Revocation of One Way (See below)

3.1 –. Yes

WARWICKSHIRE COUNTY COUNCIL

ROAD TRAFFIC REGULATION ACT 1967.

THE COUNTY OF WARWICK (WOOD STREET, SOUTHAM)

(ONE WAY TRAFFIC)ORDER 1968

COPY.

WARWICKSHIRE COUNTY COUNCIL.

ROAD TRAFFIC REGULATION ACT, 1967.

THE COUNTY OF WARWICK (WOOD STREET, SOUTHAM)
(ONE WAY TRAFFIC) ORDER, 1968.

The Warwickshire County Council, in exercise of their powers under sections 1(1), (2) and (3) and 2(4) of the Road Traffic Regulation Act, 1967, and of all other powers them enabling hereby make the following Order:-

1. No person shall, except upon the direction or with the permission of a police constable in uniform, cause any vehicle to proceed in Wood Street in the Parish of Southam otherwise than in a south-easterly direction.
2. Nothing in Article 1 of this Order shall apply to the driving of any mechanical road cleansing vehicle.
3. The Interpretation Act, 1889, shall apply for the interpretation of this Order as it applies for the interpretation of an Act of Parliament.
4. This Order shall come into operation on the seventeenth day of June One thousand nine hundred and sixty-eight and may be cited as the County of Warwick (Wood Street, Southam) (One Way Traffic) Order, 1968.

GIVEN under the Seal of the Warwickshire County Council this Twenty-first day of May, One thousand nine hundred and sixty-eight.

The Common Seal of the Warwickshire)
County Council was hereto affixed in)
the presence of:-

L.S.1968/184

(Sgd.) R. M. WILLIS,

Clerk of the Council.

4. PRIORITY

4.1 - Medium.

Southam Town Centre

Proposed Waiting Restrictions – Market Hill, High Street and Coventry Street, Southam.

1. STATEMENT OF REASONS

Warwickshire County Council are proposing to improve the links between local transport, the shops and businesses within the town centre area of Market Hill, High Street and Coventry Street, Southam. The scheme will create a safer and more welcoming environment for both residents and visitors to Southam.

The scheme will enhance the appearance of the town centre area by upgrading street furniture, the provision of a dedicated footway for pedestrians waiting for bus services, a pedestrian refuge, and an improved layout for vehicles using the short-term parking on Market Hill.

Pedestrians will be physically separated from the through-traffic on Market Hill, making a safer environment for pedestrians in this new-style environment. The number of available parking spaces in this area will be reduced to seven short-term parking bays, with two additional bays; one reserved for disabled badge holders only and one split use, part-time loading/unloading and part-time for disabled badge holders. Two additional short-term spaces and one disabled bay space would be introduced on the east side of High Street. Wood Street car park will remain free for use, being easily accessible for the town centre facilities.

Changes to the northbound Bus Stop bay on Coventry Street will reduce available on street parking by approximately 3 metres. This is to facilitate safer turning manoeuvres for buses and safer pedestrian access to the bus.

2. SCHEDULE

2.1 See Plan Ref. TR/9221-001

2.2 Schedule for Public Notice:

(No Waiting at any Time)

2.2.1 Park Lane

- (i) Both sides, from its junction with Market Hill westwards for 14 metres

2.2.2 Market Hill and Market Hill (Service road)

- (i) West side, for its entire length between the junctions with Park Lane and Warwick Steet, except for the marked parking bays as described in items 2.2.3(i), 2.2.5(i) and 2.2.6(i)
- (ii) Around the entire circumference of the island separating Market Hill from Market Hill (Service Road)

(Disabled Badge Holders Only)

2.2.3 Market Hill (Service Road)

- (i) The northern-most of the 9 marked parking spaces between Warwick Street and Park Lane

2.2.4 High Street

- (i) East side, from a point 37 metres north of its junction with Daventry Street, northwards for 6 metres

**(Loading Only, 6am-12pm)
(Disabled Badge Holders Only, 12pm-8pm)**

2.2.5 Market Hill (Service Road)

- (i) The southern-most of the 9 marked parking spaces between Warwick Street and Park Lane

(Limited Waiting, 8am-8pm - 1 hour, no return within 1 hour)

2.2.6 Market Hill (Service Road)

- (i) The centre-most 7 of the 9 marked parking spaces between Warwick Street and Park Lane

2.2.7 High Street

- (i) East side, from a point 27 metres north of its junction with Daventry Street, northwards for 10 metres

**(Limited Waiting, Mon-Sat 8am-6pm – 2 hours, no return in 2 hours,
except Permit Holders S0)**

2.2.8 Coventry Street

- (ii) West side, the existing bay fronting Acorn Stores, 12 metres in length (reduced by 3m at its northern end)

3. EXISTING ORDERS TO BE VARIED –

- 3.1 The Warwickshire County Council (District of Stratford on Avon) (Civil Enforcement Area) (Waiting Restrictions, On Street Parking Places and Residents' Parking) (Consolidation) Order 2008.

4. PRIORITY

- 4.1 – Medium.

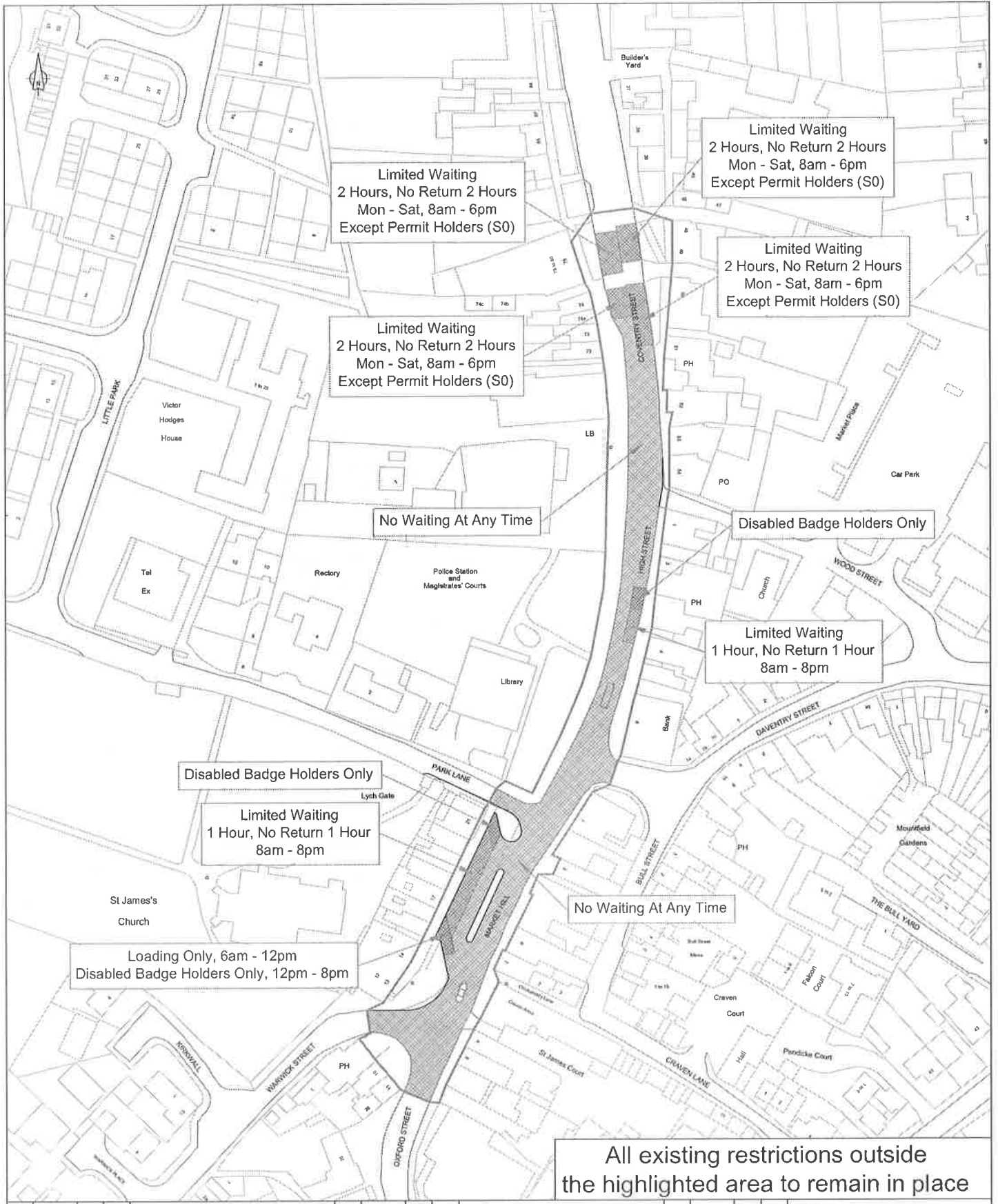

All existing restrictions outside the highlighted area to remain in place

REV	DATE	BY	CHK	AMENDMENT	REV	DATE	BY	CHK	AMENDMENT	REV	DATE	BY	CHK	AMENDMENT
-	-/-/-	-	-	-	-	-/-/-	-	-	-	-	-/-/-	-	-	-
-	-/-/-	-	-	-	-	-/-/-	-	-	-	-	-/-/-	-	-	-

Warwickshire County Council
 COMMUNITIES
 Monica Fogarty
 Strategic Director for Communities
 Greene Filton BSc, MSc, C.Eng, MICE
 Head of Transport for Warwickshire
 PO Box 41, Shire Hall
 Warwick, CV34 4SX
 Tel: (01926) 410410
 Fax: (01926) 491668
 www.warwickshire.gov.uk
 mallo:communities@warwickshire.gov.uk

NOTES
 H:\Traffic\AA_PROJECT SUPPORT\Southam\S106 CHIP low centre\Design\Street Furniture.dwg
 Based on Ordnance Survey mapping with the permission of the Controller of HMSO
 © Crown Copyright and database right 2011. Ordnance Survey 100019520
 All rights reserved.
 Unauthorised reproduction infringes copyright and may lead to prosecution or civil proceedings.
 Warwickshire County Council

Drawing title
**Waiting Restrictions
 Market Hill / High Street /
 Coventry Street
 Southam, Stratford District**
 Project title
Southam Town Centre Highway Improvement

Drawn by PM	Checked by DP
Date 11 September 2014	
Scale 1:1000 @ A3_P	
Drawing number TR/9221-001	

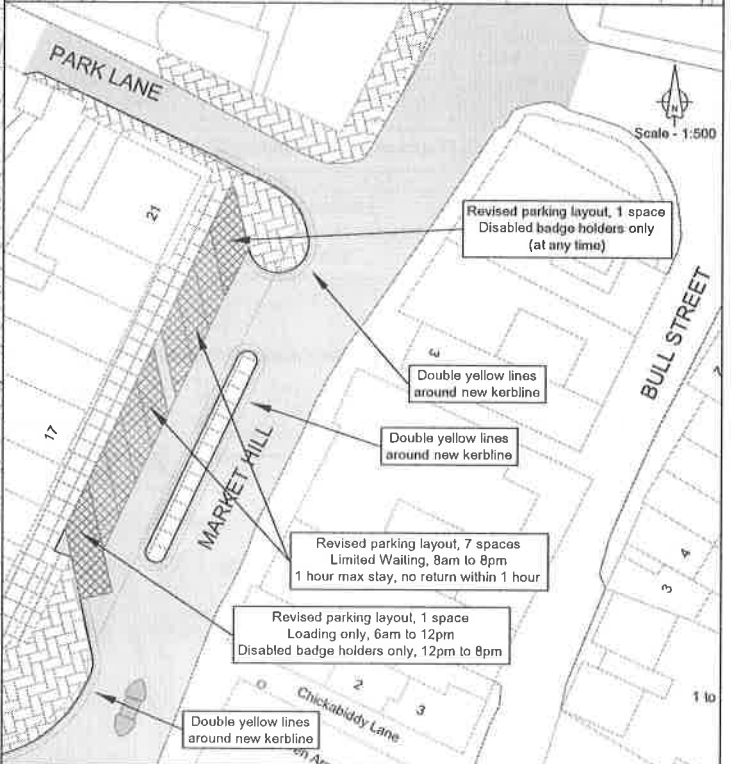
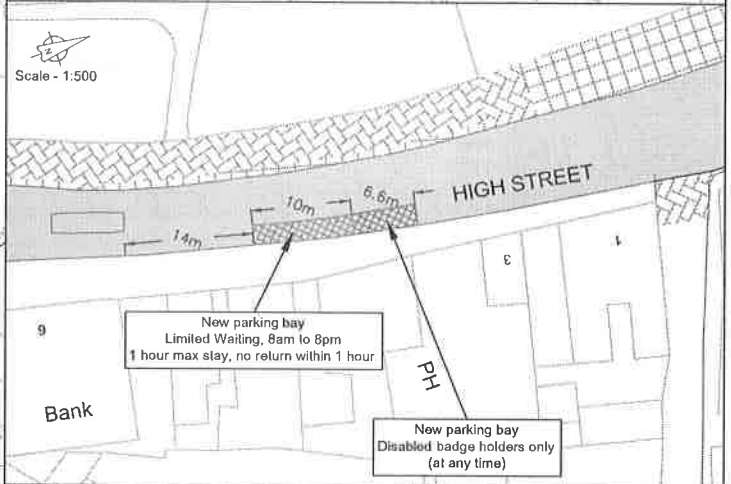
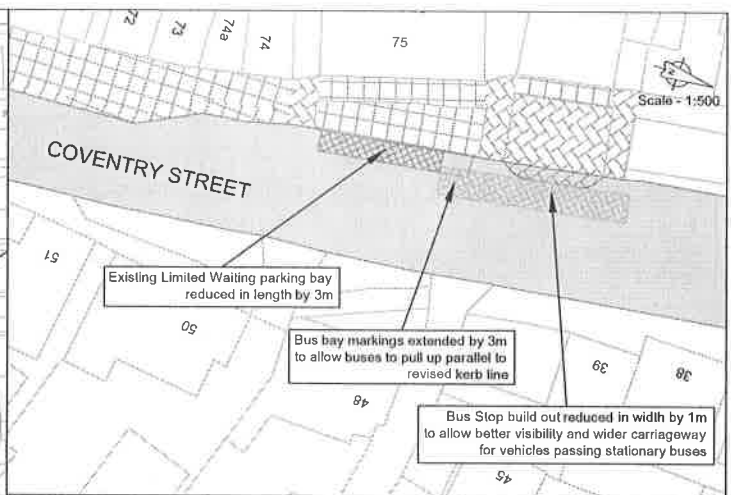
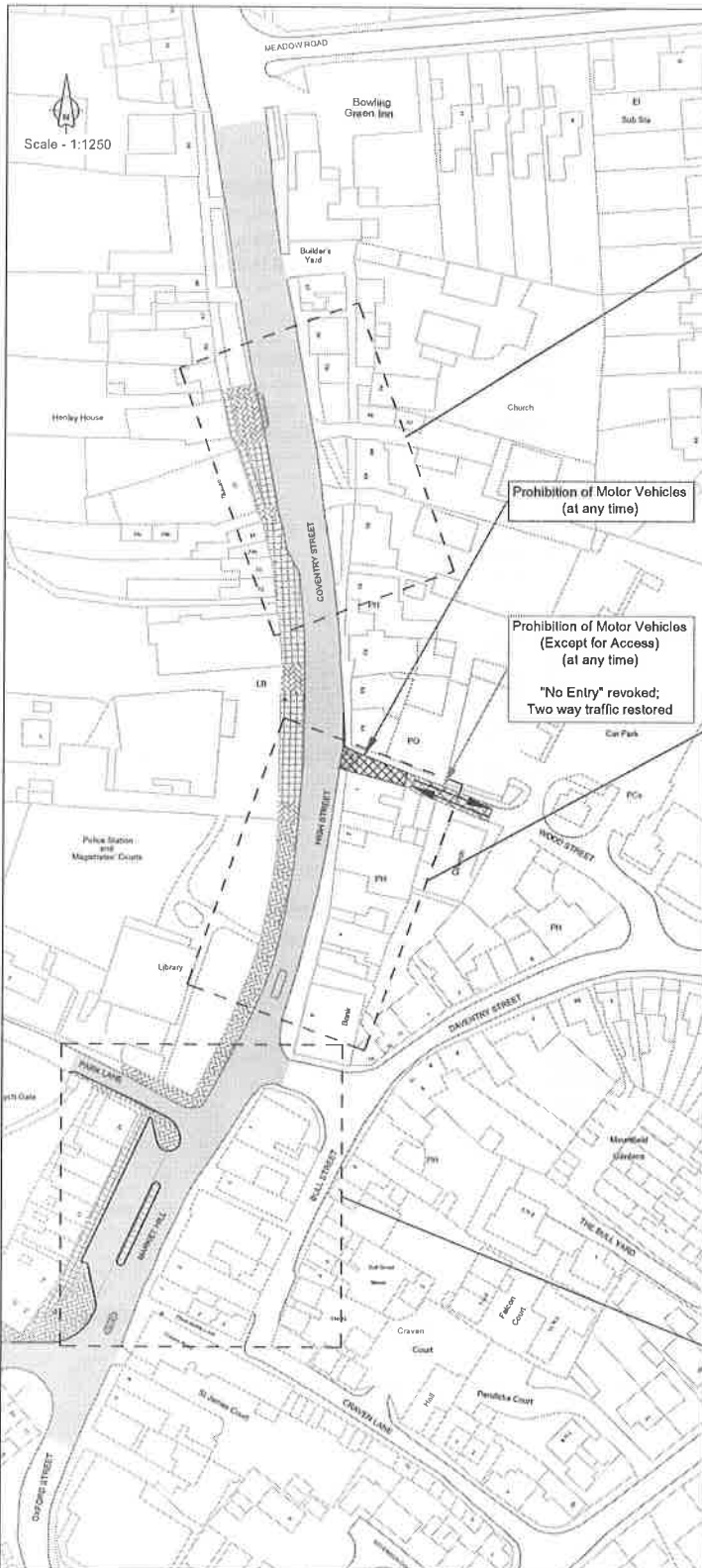

Unless stated otherwise,
all existing restrictions to remain in place

REV	DATE	BY	CHK	AMENDMENT	REV	DATE	BY	CHK	AMENDMENT	REV	DATE	BY	CHK	AMENDMENT
-	-	-	-	-	-	-	-	-	-	-	-	-	-	-
-	-	-	-	-	-	-	-	-	-	-	-	-	-	-

Warwickshire County Council

COMMUNITIES

Monica Fogarty
Strategic Director for Communities

Graeme Filten BSc, MSc, C Eng, MICE
Head of Transport for Warwickshire

PO Box 43, Shire Hall
Warwick, CV34 4SX
Tel: (01926) 410410
Fax: (01926) 491665

www.warwickshire.gov.uk
mailto:communities@warwickshire.gov.uk

NOTES

H:\Traffic\AA_PROJECT SUPPORT\Southam\5106 CHIP town centre\Design\Street Furniture.dwg

Based on Ordnance Survey mapping with the permission of the Controller of HMSO
© Crown Copyright and database right 2011, Ordnance Survey 100019520.
All rights reserved.
Unauthorized reproduction infringes copyright and may lead to prosecution or civil proceedings.
Warwickshire County Council

Drawing title

**Traffic Regulation Orders
Market Hill / High Street /
Coventry Street / Wood Street
Southam, Stratford District**

Project title

Southam Town Centre Highway Improvement

Drawn by	Checked by
PM	DP
Date	
11 September 2014	
Scale	
As Shown @A3P	
Drawing number	
TR/9221-002	

WARWICKSHIRE COUNTY COUNCIL

ROAD TRAFFIC REGULATION ACT 1984

**THE WARWICKSHIRE COUNTY COUNCIL (WOOD STREET, SOUTHAM)
(PROHIBITION OF MOTOR VEHICLES) ORDER 2014; and**

**THE WARWICKSHIRE COUNTY COUNCIL (DISTRICT OF STRATFORD ON AVON)
(CIVIL ENFORCEMENT AREA) (WAITING RESTRICTIONS, ON STREET PARKING
PLACES AND RESIDENTS' PARKING) (CONSOLIDATION) (VARIATION NO. 21)
ORDER 2014**

Warwickshire County Council propose to make the above Orders under the Road Traffic Regulation Act 1984, the effect of which will be to:

1. close to all motor vehicles at all times that length of Wood Street, Southam which is described in the Schedule 1 below;
2. to close to all motor vehicles at all times except for access that length of Wood Street, Southam which is described in Schedule 2 below; and
3. to vary the existing District of Stratford on Avon (Civil Enforcement Area) (Waiting Restrictions, On-Street Parking Places and Residents Parking) Consolidation Order 2008 as described in Schedule 3 below.

Exceptions to any waiting restrictions described in Schedule 3 below will permit waiting for the purposes of picking up and setting down passengers, loading and unloading goods, for vehicles displaying a disabled person's badge and in connection with the maintenance of the road and the supply of gas, water or electricity.

A copy of the proposed Orders, together with plans showing the lengths of road affected and a statement of the Council's reasons for proposing to make the Orders, may be inspected at the Main Reception, Shire Hall, Market Place, Warwick; at the Stratford on Avon District Council, Elizabeth House, Church Street, Stratford upon Avon; and at the Public Library, Unit 9 Brewster's Corner Pendicke Street Southam during usual opening hours.

Any enquiries relating to the proposals may be made to Phil Mitton, Communities Group, Warwickshire County Council (telephone number: 01926 412536). Any objections to the proposals, which must be in writing and specify the grounds on which they are made, should be addressed to Phil Mitton, Communities Group, PO Box 43, Shire Hall, Warwick, CV34 4SX. (Objections will normally be treated as public documents and may be communicated to other persons affected.) Objections must be sent so as to be received by 3 October 2014.

**SCHEDULE 1
(Prohibition of Motor Vehicles)**

Wood Street, Southam

That length of Wood Street which extends from its junction with High Street, eastwards for a distance of 20 metres.

**SCHEDULE 2
(Prohibition of Motor Vehicles – Except for Access)**

Wood Street, Southam

That length of Wood Street which extends from a point 20 metres east of its junction with High Street, eastwards for 25 metres.

SCHEDULE 3
(Waiting and Restrictions and Parking Places)

No Waiting at any Time

Park Lane, Southam

Both sides, from its junction with Market Hill westwards for 14 metres

Market Hill and Market Hill (Service road), Southam

(i) West side, for its entire length between the junctions with Park Lane and Warwick Street, except for the marked parking bays as described below.

(ii) Around the entire circumference of the island separating Market Hill from Market Hill (Service Road)

Disabled Badge Holders Only

Market Hill (Service Road), Southam

The northern-most of the 9 marked parking spaces between Warwick Street and Park Lane

High Street, Southam

East side, from a point 37 metres north of its junction with Daventry Street, northwards for 6 metres

Loading Only, 6am-12pm / Disabled Badge Holders Only, 12pm-8pm

Market Hill (Service Road), Southam

The southern-most of the 9 marked parking spaces between Warwick Street and Park Lane

Limited Waiting, 8am-8pm - 1 hour, no return within 1 hour

Market Hill (Service Road), Southam

The centre-most 7 of the 9 marked parking spaces between Warwick Street and Park Lane

High Street, Southam

East side, from a point 27 metres north of its junction with Daventry Street, northwards for 10 metres

Limited Waiting, Mon-Sat 8am-6pm – 2 hours, no return in 2 hours, except Permit Holders S0

Coventry Street, Southam

West side, the existing bay fronting Acorn Stores, 12 metres in length (reduced by 3 metres at its northern end)

S Duxbury
Head of Law & Governance

Shire Hall, Warwick
11 September 2014



Fwd: Parking changes in Southam

Phil Mitton <philmitton@warwickshire.gov.uk>
 To: Southam Town Centre <southamtowncentre@warwickshire.gov.uk>

30 September 2014 09:04

Phil Mitton
 Engineer
 Traffic & Road Safety Engineering
 01926 412536
www.warwickshire.gov.uk

----- Forwarded message -----

From: [REDACTED]
 Date: 29 September 2014 10:24
 Subject: Parking changes in Southam
 To: Phil Mitton WarwickshireDC <philmitton@warwickshire.gov.uk>

FAO Phil Mitton

Proposed Prohibition of Driving & Revocation of One Way – Wood Street

Proposed Waiting Restrictions –Market Hill, Park Lane, High Street, Coventry Street,

Meadow Road, Wood Street, Proposed Disabled Parking - Market Hill

Dear Mr Mitton

I would like to comment on the proposed changes to the parking in Southam, particularly re the Market Hill area.

Having looked at the plans and read the proposals I can see, appreciate and understand the reasons for altering this in relation to safety particularly in terms of having a refuge area / division between the parking and bus stop. I am however concerned in terms of the reduction in spaces and looking at the plans would ask if the addition paving at each end could be reduced to allow a further 2 spaces, which would give 9 + 2 spaces as opposed to the current 7 +2 proposed. I am extremely concerned about this reduction as this area is frequently used for short parking stops to the chemist, bank and take aways and believe this reduction in spaces which (1) have a further adverse impact on Southam business's who are still struggling to fight back and bring back in customers who no longer visit the town centre since Tesco arrived and (2) will cause people to start parking inappropriately if not dangerously elsewhere, nearby to collect their food, and by sorting out one area another problem is likely to be created nearby. People will not want to park in Wood street and walk, it may only be a matter of minutes, but their food will be getting colder by that delay. For example, there are already areas where parking is verging on dangerous, such as driving from Market Hill, past the Black Dog and down by the Church onto Warwlc road, is frequently congested on that left hand side leaving one having to wait on a blind bend as others behind you come off Market Hill , waiting to grab an opportunity to over take the long run of cars parked right down to the bridge. With traffic approaching the other way off a bend and not visible until late on this is often a risky manoeuvre.

I live in Long Itchington and frequently visit Southam using the local shops and parking on Market Hill, in Wood Street and other on street parking. To see the impact of Tesco's arrival has been heart breaking (though no surprise); a strange irony that I am told their funds are funding this! I am keen to ensure the best for Southam shops. When I am shopping at Acorn or Coop or popping to Goodwin's I want to park close by for carrying my shopping and this is possible, but equally when picking up a take away or a prescription for my sick child being able to do this quickly and conveniently is a priority. If anything it would be good to see more not less parking on the main street to encourage people in. Drive in/angled spaces similar to proposed on Market Hill could be added near Acorns and Martins with the bus stop moved slightly nearer/ opposite the Bowling Green? With restrictions of say 1 hour this too could help to encourage people in to the town.

Yours sincerely





Re: Market Hill Southam - proposed parking changes

E-mail

Southam Town Centre <southamtowncentre@warwickshire.gov.uk>

25 October 2014 20:43

To: Phil Mitton <philmitton@warwickshire.gov.uk>

Dear [REDACTED]

Thank you for your Email concerning the above,
firstly thank you for taking the time to put forward your comments.

My response to your Email is set out below,

1) Improved links between local transport - the provision of a waiting area (hard standing) on Market Hill for residents to access local bus services, and the provision of a pedestrian refuge to cross Market Hill will encourage more pedestrians to cross to the local shops and use the local bus service more safely.

2) The parking on Market Hill is extensively used and I don't see any mitigation in the proposals for the valid uses which include:

- Access to local business – what is being done to avoid loss of trade and potentially threaten the viability of the High Street?
- High visibility venue for farmers market to support rural communities – what is the alternative venue proposed and how is its suitability rated?

The proposed regulations include a 1 hour turn over for parking on Market Hill enabling a turn over of customers accessing the local businesses, this will be enforced. The intention is to use this area for all manner of events in the future, but still have the use of Wood Street Car Park. The Decision on what events use Market Hill will be decided by the Local Businesses, Southam Town Council and Stratford District Council.

Kind Regards

Graham Stanley
Senior Engineer
Traffic and Road Safety Group
Communities
Warwickshire County Council
Tel No 01926 412640
Minicon 01926 412277
Mobile 07841930586
grahamstanley@warwickshire.gov.uk
www.warwickshire.gov.uk

Phil Mitton
Project Manager
Southam Town Centre Highway Improvement Project
01926 412536

On 30 September 2014 09:04, Phil Mitton <philmitton@warwickshire.gov.uk> wrote:

Phil Mitton
Engineer
Traffic & Road Safety Engineering
01926 412536
www.warwickshire.gov.uk

----- Forwarded message -----

From: [REDACTED]
Date: 29 September 2014 22:47
Subject: Market Hill Southam - proposed parking changes
To: philmitton@warwickshire.gov.uk

Dear Mr Mitton,

Having just heard of these proposed changes and reviewed the details on the Southam Council website I would like to make some comments on these proposed changes.

1 - The proposal claims to improve links between local transport but this appears to be empty words as nowhere in the proposal is this explained.

2 - The parking on Market Hill is extensively used and I don't see any mitigation in the proposals for the valid uses which include:

- Access to local business – what is being done to avoid loss of trade and potentially threaten the viability of the High Street?
- High visibility venue for farmers market to support rural communities – what is the alternative venue proposed and how is its suitability rated?

I would be interested in your comments on this perspective.

Your sincerely

[REDACTED]



OBJECTION /
SUPPORT

Fwd: Driving and Parking Changes to Southam Town Centre

1 message

Phil Mitton <philmitton@warwickshire.gov.uk>

30 September 2014 09:04

To: Southam Town Centre <southamtowncentre@warwickshire.gov.uk>

Phil Mitton
Engineer
Traffic & Road Safety Engineering
01926 412536
www.warwickshire.gov.uk

----- Forwarded message -----

From: [REDACTED]
Date: 29 September 2014 18:19
Subject: Driving and Parking Changes to Southam Town Centre
To: philmitton@warwickshire.gov.uk

Sirs

I am a resident of Long Itchington and frequently visit Southam Town Centre to use the few remaining facilities. I have seen the proposed changes to Wood Street, Market Hill and High Street and wish to express my views as follows.

- a) The closure of Wood Street is a good idea and I support it.
- b) The changes to the bus bay markings on High Street are a good idea and I support them.
- c) The additional parking on High Street again I support.
- d) I do NOT support the proposed changes to parking on Market Hill reducing the number of bays. The only thing wrong with the present arrangements is when cars parking outside the marked bays force buses to stop on the road. The fact that cars do park there suggests that there are already insufficient parking spaces and reducing them will make matters worse. I'm also unclear as to what is happening to that bus stop as it is not shown on the plan of the changes. If buses are to continue to stop here then chaos will result as they will block the road. If the stop is being removed then what is the point of the new island? If these changes go ahead then the chip shop plus the Chinese and Indian takeaways will lose my business. I am also a regular user of the pharmacy and would probably in future get my monthly prescription from the surgery instead and pick it up when I happen to be in Leamington rather than using Southam. Please rethink this proposal, it makes no sense and will accelerate the decline of Southam town centre. The money can be better spent elsewhere.

[REDACTED]

objection ①

RECEIVED - 6 OCT 2014	
COMMUNITIES GROUP	
LEADERSHIP TEAM	
GROUP	

Date:

Dear Sir/Madam

I am writing in respect of the proposed improvements around the Market Hill area in Southam Town Centre.

As a business owner here who is going to be affected daily by this I wish to raise my objections.

The car park is being made far too small – the population is forever rising why are we cutting the number of parking spaces? – We are cutting the car park in half to make way for two paved areas – why? What purpose will they serve? The car park works as it is because it is easily accessible, so why decide to make it as difficult as possible for people to be able to use the facilities. Making more parking spaces in Wood Street will not be a helpful substitute for the convenience of the shoppers who use the Market Hill area.

We have to consider the people who use the car park on a regular basis – the elderly, disabled, families with young children etc (all people who need the convenience of the car park) to use the local services offered, ie bank, chemist post office & other local shops & amenities – It would seem that this been designed specifically like this to make it as difficult as possible for them so they will not come here to use the services here?

The idea of a raised area for buses to stop & let people alight from the bus is ludicrous – someone is going to be seriously injured here – there is a designated bus stop up the road that the bus has been using for years – why do we suddenly need to cause chaos around the shopping area?

Southam Town Council need to consider that this will have a very serious impact on the local businesses when we are already in a very difficult time – this could even force some businesses to close & soon we will be left with no local services whatsoever – this is not in the best interests of the residents of Southam surely?

To have a thriving community we need to be encouraging more local services & to help the ones we already have – these proposed works are another nail in the coffin of the independent retailers.

Whilst the £320,000 donation from Tesco's is a very generous offer – It is very difficult not to think that the sole intention of it is to eradicate every small local business in the town thereby gaining more customers for themselves.

If it is really a gift then it should be used to improve the town properly not annihilate the livelihoods of local sole retailers, some who have been here many years.

I would suspect the only reason the donation has been made is for the above mentioned points, otherwise why not use the money elsewhere? Or has it specifically been given to tear the heart out of Market Hill?

Yours Sincerely

A handwritten signature in black ink, appearing to be 'A. H. B.', written in a cursive style.

Objection

[REDACTED]

Date: 30.09.2014

Dear Sir/Madam

I am writing in respect of the proposed improvements around the Market Hill area in Southam Town Centre.

As a business owner here who is going to be affected daily by this I wish to raise my objections.

The car park is being made far too small – the population is forever rising why are we cutting the number of parking spaces? – We are cutting the car park in half to make way for two paved areas – why? What purpose will they serve? The car park works as it is because it is easily accessible, so why decide to make it as difficult as possible for people to be able to use the facilities. Making more parking spaces in Wood Street will not be a helpful substitute for the convenience of the shoppers who use the Market Hill area.

We have to consider the people who use the car park on a regular basis – the elderly, disabled, families with young children etc (all people who need the convenience of the car park) to use the local services offered, ie bank, chemist post office & other local shops & amenities – It would seem that this been designed specifically like this to make it as difficult as possible for them so they will not come here to use the services here?

The idea of a raised area for buses to stop & let people alight from the bus is ludicrous – someone is going to be seriously injured here – there is a designated bus stop up the road that the bus has been using for years – why do we suddenly need to cause chaos around the shopping area?

Southam Town Council need to consider that this will have a very serious impact on the local businesses when we are already in a very difficult time – this could even force some businesses to close & soon we will be left with no local services whatsoever – this is not in the best interests of the residents of Southam surely?

To have a thriving community we need to be encouraging more local services & to help the ones we already have – these proposed works are another nail in the coffin of the independent retailers.

Whilst the £320,000 donation from Tesco's is a very generous offer – It is very difficult not to think that the sole intention of it is to eradicate every small local business in the town thereby gaining more customers for themselves.

If it is really a gift then it should be used to improve the town properly not annihilate the livelihoods of local sole retailers, some who have been here many years.

I would suspect the only reason the donation has been made is for the above mentioned points, otherwise why not use the money elsewhere? Or has it specifically been given to tear the heart out of Market Hill?

I & the rest of the businesses here on Market Hill would also like to let you know that if these works go ahead to reduce the car parking spaces then we will be all making a claim against yourselves for loss of business whilst the works are ongoing.

We will also be looking for a reduction in our business rates as we are now taking advice from a company who will carry out a business rates survey on our behalf & pursue the matter with us.

Yours Sincerely

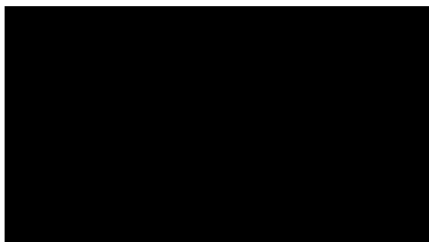

Received 1/10/2014 Petition



Date: 30.09.2014

Dear Sir/Madam

I am writing in respect of the proposed improvements around the Market Hill area in Southam Town Centre.

Please find enclosed a petition signed by residents of Southam & the surrounding villages which includes all the people who use the parking facilities here on Market Hill, we wish to show our objections to the proposed works.

Yours Sincerely

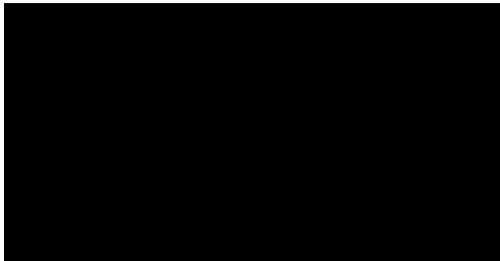

1029 Signatures

1

We have a final chance to raise our objections to Southam Town Council ruining the heart of Southam. By reducing the car park spaces from 14 to 9. You will have to park at Wood Street to do your Banking, picking your Prescription and convenience of popping in for Southams Take aways
Tesco paying £320,000 to modernise the town should be used wisely, not to hinder the use of town centre for Tescos Benefit

Please Sign the Petition to Say No To Changes to Parking at Market Hill

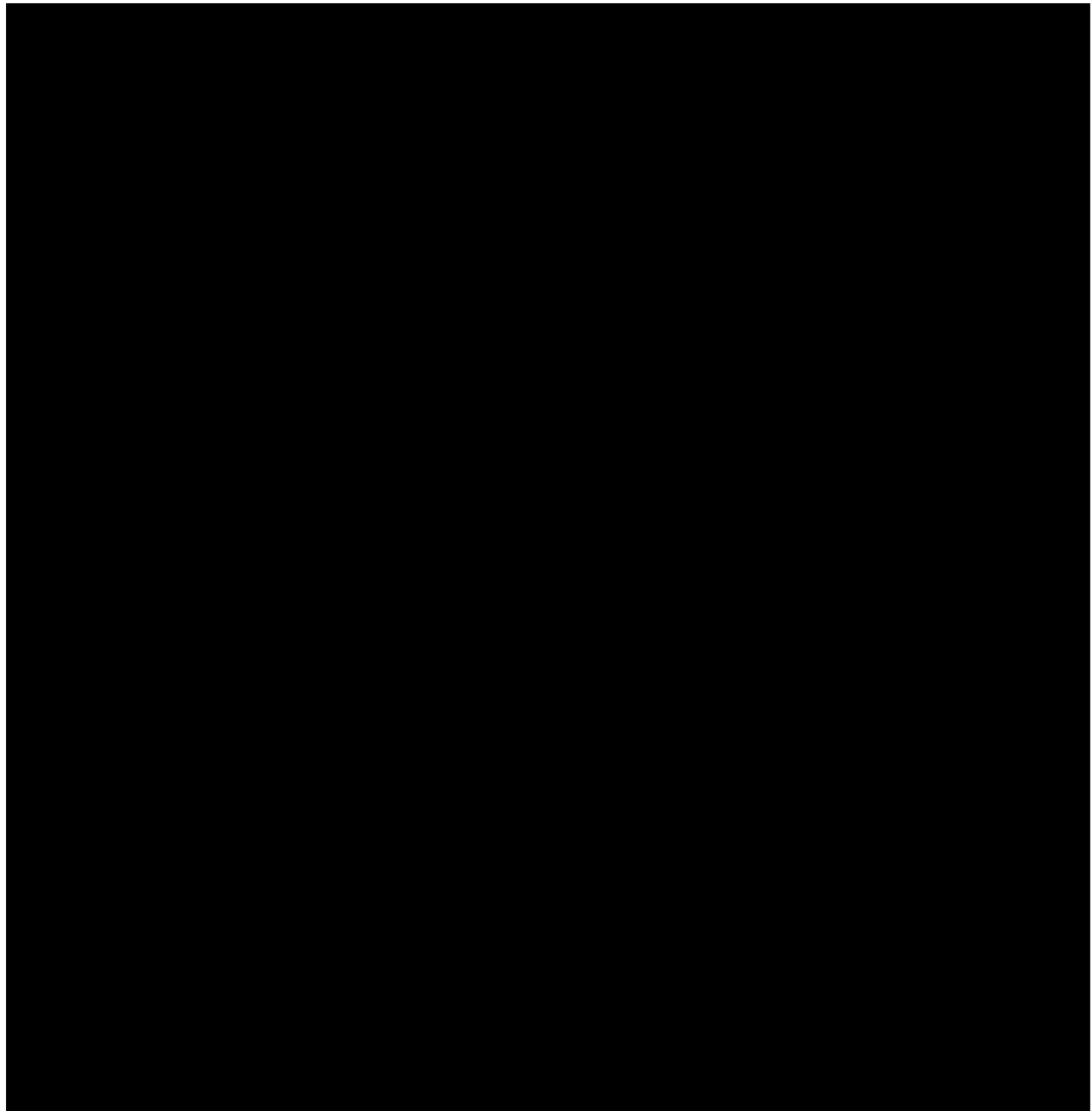

34